

DELIVERED GOODS FORM

PATIENT INFORMATION

Hospital: _____

Account Number: _____

Surgery Date: _____ OR #: _____

Surgeon: _____

Procedure: _____

Received by: _____

Rep Name & Company: _____

ITEM #	COLOR	DESCRIPTION	QTY	UNIT PRICE	TOTAL
10-700-070060A-0	BLACK				
10-700-07006BA-0	BLUE	Dual Hole Full Ring, 70mm ID, Aluminum			
10-700-07006UA-0	PURPLE				
10-700-080060A-0	BLACK				
10-700-08006BA-0	BLUE	Dual Hole Full Ring, 80mm ID, Aluminum			
10-700-08006UA-0	PURPLE				
10-700-090060A-0	BLACK				
10-700-09006BA-0	BLUE	Dual Hole Full Ring, 90mm ID, Aluminum			
10-700-09006UA-0	PURPLE				
50-1012-10A-WB	BLACK				
10-700-10506BA-0	BLUE	Dual Hole Full Ring, 105mm ID, Aluminum			
10-700-10506UA-0	PURPLE				
50-1012-12A-WB	BLACK				
10-700-12006BA-0	BLUE	Dual Hole Full Ring, 120mm ID, Aluminum			
10-700-12006UA-0	PURPLE				
50-1012-13A-WB	BLACK				
10-700-13506BA-0	BLUE	Dual Hole Full Ring, 135mm ID, Aluminum			
10-700-13506UA-0	PURPLE				
50-1012-15A-WB	BLACK				
10-700-15006BA-0	BLUE	Dual Hole Full Ring, 150mm ID, Aluminum			
10-700-15006UA-0	PURPLE				
50-1012-16A-WB	BLACK				
10-700-16506BA-0	BLUE	Dual Hole Full Ring, 165mm ID, Aluminum			
10-700-16506UA-0	PURPLE				
50-1012-18A-WB	BLACK				
10-700-18006BA-0	BLUE	Dual Hole Full Ring, 180mm ID, Aluminum			
10-700-18006UA-0	PURPLE				
50-1012-19A-WB	BLACK				
10-700-19506BA-0	BLUE	Dual Hole Full Ring, 195mm ID, Aluminum			
10-700-19506UA-0	PURPLE				
50-1012-21A-WB	BLACK				
10-700-21006BA-0	BLUE	Dual Hole Full Ring, 210mm ID, Aluminum			
10-700-21006UA-0	PURPLE				
50-1012-22A-WB	BLACK				
10-700-22506BA-0	BLUE	Dual Hole Full Ring, 225mm ID, Aluminum			
10-700-22506UA-0	PURPLE				
50-1012-24A-WB	BLACK				
10-700-24006BA-0	BLUE	Dual Hole Full Ring, 240mm ID, Aluminum			
10-700-24006UA-0	PURPLE				

FULL RINGS

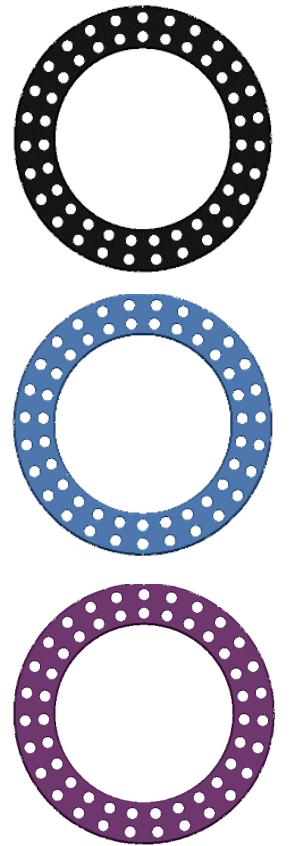

DELIVERED GOODS FORM (CONTINUED)

2/3 RINGS

ITEM #	COLOR	DESCRIPTION	QTY	UNIT PRICE	TOTAL
10-700-070280A-0	BLACK				
10-700-07028BA-0	BLUE	Dual Hole 2/3 Ring, 70mm ID, Aluminum			
10-700-07028UA-0	PURPLE				
10-700-080280A-0	BLACK				
10-700-08028BA-0	BLUE	Dual Hole 2/3 Ring, 80mm ID, Aluminum			
10-700-08028UA-0	PURPLE				
10-700-090280A-0	BLACK				
10-700-09028BA-0	BLUE	Dual Hole 2/3 Ring, 90mm ID, Aluminum			
10-700-09028UA-0	PURPLE				
50-1017-10A-WB	BLACK				
10-700-10528BA-0	BLUE	Dual Hole 2/3 Ring, 105mm ID, Aluminum			
10-700-10528UA-0	PURPLE				
50-1017-12A-WB	BLACK				
10-700-12028BA-0	BLUE	Dual Hole 2/3 Ring, 120mm ID, Aluminum			
10-700-12028UA-0	PURPLE				
50-1017-13A-WB	BLACK				
10-700-13528BA-0	BLUE	Dual Hole 2/3 Ring, 135mm ID, Aluminum			
10-700-13528UA-0	PURPLE				
50-1017-15A-WB	BLACK				
10-700-15028BA-0	BLUE	Dual Hole 2/3 Ring, 150mm ID, Aluminum			
10-700-15028UA-0	PURPLE				
50-1017-16A-WB	BLACK				
10-700-16528BA-0	BLUE	Dual Hole 2/3 Ring, 165mm ID, Aluminum			
10-700-16528UA-0	PURPLE				
50-1017-18A-WB	BLACK				
10-700-18028BA-0	BLUE	Dual Hole 2/3 Ring, 180mm ID, Aluminum			
10-700-18028UA-0	PURPLE				
50-1017-19A-WB	BLACK				
10-700-19528BA-0	BLUE	Dual Hole 2/3 Ring, 195mm ID, Aluminum			
10-700-19528UA-0	PURPLE				
50-1017-21A-WB	BLACK				
10-700-21028BA-0	BLUE	Dual Hole 2/3 Ring, 210mm ID, Aluminum			
10-700-21028UA-0	PURPLE				
50-1017-22A-WB	BLACK				
10-700-22528BA-0	BLUE	Dual Hole 2/3 Ring, 225mm ID, Aluminum			
10-700-22528UA-0	PURPLE				
50-1017-24A-WB	BLACK				
10-700-24028BA-0	BLUE	Dual Hole 2/3 Ring, 240mm ID, Aluminum			
10-700-24028UA-0	PURPLE				

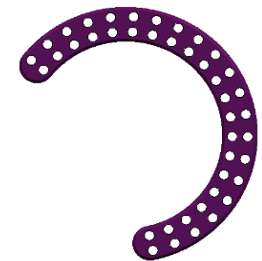
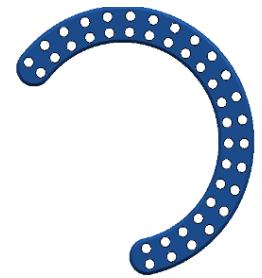
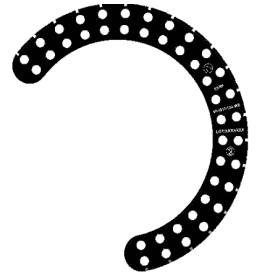

DELIVERED GOODS FORM (CONTINUED)

1/3 RINGS

ITEM #	COLOR	DESCRIPTION	QTY	UNIT PRICE	TOTAL
50-1018-10A-WB	BLACK	Dual Hole 1/3 Ring, 105mm ID, Aluminum			
50-1018-12A-WB	BLACK	Dual Hole 1/3 Ring, 120mm ID, Aluminum			
50-1018-13A-WB	BLACK	Dual Hole 1/3 Ring, 135mm ID, Aluminum			
50-1018-15A-WB	BLACK	Dual Hole 1/3 Ring, 150mm ID, Aluminum			
50-1018-16A-WB	BLACK	Dual Hole 1/3 Ring, 165mm ID, Aluminum			
50-1018-18A-WB	BLACK	Dual Hole 1/3 Ring, 180mm ID, Aluminum			
50-1018-19A-WB	BLACK	Dual Hole 1/3 Ring, 195mm ID, Aluminum			
50-1018-21A-WB	BLACK	Dual Hole 1/3 Ring, 210mm ID, Aluminum			
50-1018-22A-WB	BLACK	Dual Hole 1/3 Ring, 225mm ID, Aluminum			
50-1018-24A-WB	BLACK	Dual Hole 1/3 Ring, 240mm ID, Aluminum			



FOOT RINGS

ITEM #	COLOR	DESCRIPTION	QTY	UNIT PRICE	TOTAL
50-1015-01-WB	BLACK	Foot Ring, Small, Aluminum			
50-1015-03-WB	BLACK	Foot Ring, Medium, Aluminum			
50-1015-02-WB	BLACK	Foot Ring, Large, Aluminum			

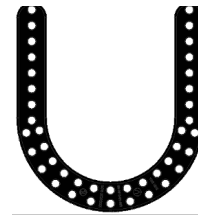

ITEM #	DESCRIPTION	QTY	UNIT PRICE	TOTAL
50-1018-00A-WB	Dual Hole 1/3 - 2/3 Ring Connector			



DUAL JOINT STRUTS

ITEM #	DESCRIPTION	QTY	UNIT PRICE	TOTAL
50-1032-00-WB	Dual Joint Exp. Strut, XXShort			
50-1032-01-WB	Dual Joint Exp. Strut, XShort			
50-1032-02-WB	Dual Joint Exp. Strut, Short			
50-1032-03-WB	Dual Joint Exp. Strut, Medium			
50-1032-04-WB	Dual Joint Exp. Strut, Long			
50-1031-00-WB	Dual Joint Standard Strut, XXShort			
50-1031-01-WB	Dual Joint Standard Strut, XShort			
50-1031-02-WB	Dual Joint Standard Strut, Short			
50-1031-03-WB	Dual Joint Standard Strut, Medium			
50-1031-04-WB	Dual Joint Standard Strut, Long			



DELIVERED GOODS FORM (CONTINUED)

CLAMPS

ITEM #	DESCRIPTION	QTY	UNIT PRICE	TOTAL
50-1041-00-WB	Standard Wire Clamp			
50-1042-30-WB	Advanced Pin Clamp			
50-1042-00-WB	Standard Pin Clamp			
50-1043-01-WB	Advanced Clamp Post - Small, 26mm			
50-1043-02-WB	Advanced Clamp Post - Large, 42mm			
50-1044-00-WB	Side Load Wire Clamp			

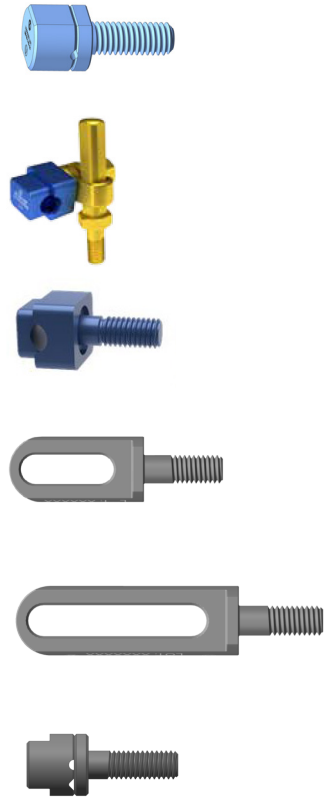

CUBES

ITEM #	DESCRIPTION	QTY	UNIT PRICE	TOTAL
50-1041-00-WB	Cube, 1-Hole			
50-1042-30-WB	Cube, 2-Hole			
50-1042-00-WB	Cube, 3-Hole			
50-1043-01-WB	Cube, 4-Hole			
50-1043-02-WB	Cube, 5-Hole			
50-1044-00-WB	Set Screw, 6mm			
50-1056-60-WB	Pin Sleeve for Cube, 6mm			

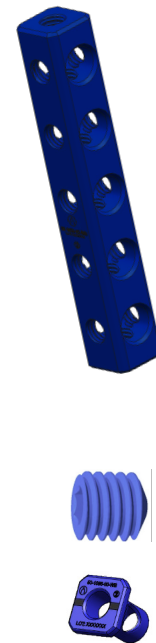

DELIVERED GOODS FORM (CONTINUED)

NUTS, BOLTS, WASHERS

ITEM #	DESCRIPTION	QTY	UNIT PRICE	TOTAL
50-1052-01-WB	Standard Nut			
50-1052-03-WB	Long Nut (12.8mm)			
50-1053-12-WB	Connection Bolt, Short, 12mm			
50-1053-16-WB	Connection Bolt, Medium, 16mm			
50-1053-20-WB	Connection Bolt, Long, 20mm			
50-1153-06-WB	Shoulder Bolt, 6mm			
50-1153-08-WB	Shoulder Bolt, 8mm			
50-1051-00-WB	Washer			
50-1051-01-WB	Locking Washer			

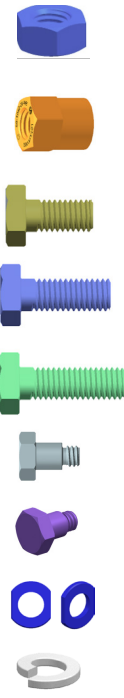

ITEM #	DESCRIPTION	QTY	UNIT PRICE	TOTAL
50-1054-20-WB	Dual Rod Connector, Short			
50-1054-40-WB	Dual Rod Connector, Medium			
50-1054-60-WB	Dual Rod Connector, Long			

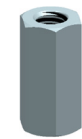

THREADED RODS

ITEM #	DESCRIPTION	QTY	UNIT PRICE	TOTAL
50-1057-60S-WB	Threaded Rod, 60mm Length, SS			
50-1057-80S-WB	Threaded Rod, 80mm Length, SS			
50-1057-100S-WB	Threaded Rod, 100mm Length, SS			
50-1057-120S-WB	Threaded Rod, 120mm Length, SS			
50-1057-150S-WB	Threaded Rod, 150mm Length, SS			
50-1057-200S-WB	Threaded Rod, 200mm Length, SS			
50-1057-250S-WB	Threaded Rod, 250mm Length, SS			
50-1057-300S-WB	Threaded Rod, 300mm Length, SS			

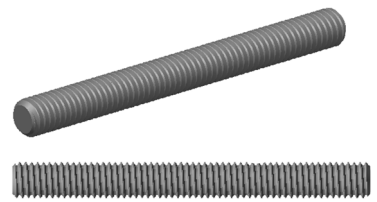

WIRES

ITEM #	DESCRIPTION	QTY	UNIT PRICE	TOTAL
50-1071-16S-WB	Wire - 1.6mm, Bayonet Tip, SS			
50-1071-20S-WB	Wire - 2.0mm, Bayonet Tip, SS			
50-1072-16S-WB	Olive Wire - 1.6mm, Bayonet Tip, SS			
50-1072-20S-WB	Olive Wire - 2.0mm, Bayonet Tip, SS			
50-1062-00S-WB	Wire Stopper Washer, SS			

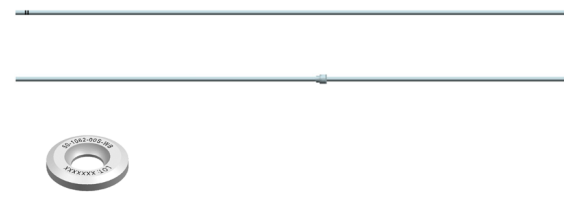

SELF DRILLING HALF PINS



	ITEM #	DESCRIPTION	QTY	UNIT PRICE	TOTAL
4.5MM	50-1845-122S-WB	Half Pin, 4.5/120/20mm, Self Drilling, QC, SS			
	50-1845-123S-WB	Half Pin, 4.5/120/30mm, Self Drilling, QC, SS			
	50-1845-124S-WB	Half Pin, 4.5/120/40mm, Self Drilling, QC, SS			
	50-1845-152S-WB	Half Pin, 4.5/150/20mm, Self Drilling, QC, SS			
	50-1845-153S-WB	Half Pin, 4.5/150/30mm, Self Drilling, QC, SS			
	50-1845-154S-WB	Half Pin, 4.5/150/40mm, Self Drilling, QC, SS			
	50-1845-155S-WB	Half Pin, 4.5/150/50mm, Self Drilling, QC, SS			
5.0MM	50-1850-123S-WB	Half Pin, 5.0/120/30mm, Self Drilling, QC, SS			
	50-1850-124S-WB	Half Pin, 5.0/120/40mm, Self Drilling, QC, SS			
	50-1850-153S-WB	Half Pin, 5.0/150/30mm, Self Drilling, QC, SS			
	50-1850-154S-WB	Half Pin, 5.0/150/40mm, Self Drilling, QC, SS			
	50-1850-155S-WB	Half Pin, 5.0/150/50mm, Self Drilling, QC, SS			
	50-1850-183S-WB	Half Pin, 5.0/180/30mm, Self Drilling, QC, SS			
	50-1850-184S-WB	Half Pin, 5.0/180/40mm, Self Drilling, QC, SS			
	50-1850-185S-WB	Half Pin, 5.0/180/50mm, Self Drilling, QC, SS			
	50-1850-203S-WB	Half Pin, 5.0/200/30mm, Self Drilling, QC, SS			
	50-1850-204S-WB	Half Pin, 5.0/200/40mm, Self Drilling, QC, SS			
	50-1850-205S-WB	Half Pin, 5.0/200/50mm, Self Drilling, QC, SS			
	50-1850-223S-WB	Half Pin, 5.0/220/30mm, Self Drilling, QC, SS			
	50-1850-224S-WB	Half Pin, 5.0/220/40mm, Self Drilling, QC, SS			
	50-1850-225S-WB	Half Pin, 5.0/220/50mm, Self Drilling, QC, SS			
	50-1850-253S-WB	Half Pin, 5.0/250/30mm, Self Drilling, QC, SS			
	50-1850-254S-WB	Half Pin, 5.0/250/40mm, Self Drilling, QC, SS			
	50-1850-255S-WB	Half Pin, 5.0/250/50mm, Self Drilling, QC, SS			
6.0MM	50-1860-153S-WB	Half Pin, 6.0/150/30mm, Self Drilling, QC, SS			
	50-1860-154S-WB	Half Pin, 6.0/150/40mm, Self Drilling, QC, SS			
	50-1860-183S-WB	Half Pin, 6.0/180/30mm, Self Drilling, QC, SS			
	50-1860-184S-WB	Half Pin, 6.0/180/40mm, Self Drilling, QC, SS			
	50-1860-203S-WB	Half Pin, 6.0/200/30mm, Self Drilling, QC, SS			
	50-1860-204S-WB	Half Pin, 6.0/200/40mm, Self Drilling, QC, SS			
	50-1860-205S-WB	Half Pin, 6.0/200/50mm, Self Drilling, QC, SS			
	50-1860-223S-WB	Half Pin, 6.0/220/30mm, Self Drilling, QC, SS			
	50-1860-224S-WB	Half Pin, 6.0/220/40mm, Self Drilling, QC, SS			
	50-1860-225S-WB	Half Pin, 6.0/220/50mm, Self Drilling, QC, SS			
	50-1860-253S-WB	Half Pin, 6.0/250/30mm, Self Drilling, QC, SS			
	50-1860-254S-WB	Half Pin, 6.0/250/40mm, Self Drilling, QC, SS			
	50-1860-255S-WB	Half Pin, 6.0/250/50mm, Self Drilling, QC, SS			

BLUNT SELF TAPPING HALF PINS



	ITEM #	DESCRIPTION	QTY	UNIT PRICE	TOTAL
4.5mm	50-1845-122BL-WB	Half Pin, 4.5/120/20mm, Blunt Self Tapping, QC, SS			
	50-1845-123BL-WB	Half Pin, 4.5/120/30mm, Blunt Self Tapping, QC, SS			
	50-1845-124BL-WB	Half Pin, 4.5/120/40mm, Blunt Self Tapping, QC, SS			
	50-1845-153BL-WB	Half Pin, 4.5/150/30mm, Blunt Self Tapping, QC, SS			
	50-1845-154BL-WB	Half Pin, 4.5/150/40mm, Blunt Self Tapping, QC, SS			
5.0mm	50-1850-123BL-WB	Half Pin, 5.0/120/30mm, Blunt Self Tapping, QC, SS			
	50-1850-124BL-WB	Half Pin, 5.0/120/40mm, Blunt Self Tapping, QC, SS			
	50-1850-153BL-WB	Half Pin, 5.0/150/30mm, Blunt Self Tapping, QC, SS			
	50-1850-154BL-WB	Half Pin, 5.0/150/40mm, Blunt Self Tapping, QC, SS			
	50-1850-155BL-WB	Half Pin, 5.0/150/50mm, Blunt Self Tapping, QC, SS			
	50-1850-183BL-WB	Half Pin, 5.0/180/30mm, Blunt Self Tapping, QC, SS			
	50-1850-184BL-WB	Half Pin, 5.0/180/40mm, Blunt Self Tapping, QC, SS			
	50-1850-185BL-WB	Half Pin, 5.0/180/50mm, Blunt Self Tapping, QC, SS			
	50-1850-203BL-WB	Half Pin, 5.0/200/30mm, Blunt Self Tapping, QC, SS			
	50-1850-204BL-WB	Half Pin, 5.0/200/40mm, Blunt Self Tapping, QC, SS			
	50-1850-205BL-WB	Half Pin, 5.0/200/50mm, Blunt Self Tapping, QC, SS			
	50-1850-223BL-WB	Half Pin, 5.0/220/30mm, Blunt Self Tapping, QC, SS			
	50-1850-224BL-WB	Half Pin, 5.0/220/40mm, Blunt Self Tapping, QC, SS			
	50-1850-225BL-WB	Half Pin, 5.0/220/50mm, Blunt Self Tapping, QC, SS			
	50-1850-253BL-WB	Half Pin, 5.0/250/30mm, Blunt Self Tapping, QC, SS			
50-1850-254BL-WB	Half Pin, 5.0/250/40mm, Blunt Self Tapping, QC, SS				
50-1850-255BL-WB	Half Pin, 5.0/250/50mm, Blunt Self Tapping, QC, SS				
6.0mm	50-1860-153BL-WB	Half Pin, 6.0/150/30mm, Blunt Self Tapping, QC, SS			
	50-1860-154BL-WB	Half Pin, 6.0/150/40mm, Blunt Self Tapping, QC, SS			
	50-1860-183BL-WB	Half Pin, 6.0/180/30mm, Blunt Self Tapping, QC, SS			
	50-1860-184BL-WB	Half Pin, 6.0/180/40mm, Blunt Self Tapping, QC, SS			
	50-1860-203BL-WB	Half Pin, 6.0/200/30mm, Blunt Self Tapping, QC, SS			
	50-1860-204BL-WB	Half Pin, 6.0/200/40mm, Blunt Self Tapping, QC, SS			
	50-1860-205BL-WB	Half Pin, 6.0/200/50mm, Blunt Self Tapping, QC, SS			
	50-1860-223BL-WB	Half Pin, 6.0/220/30mm, Blunt Self Tapping, QC, SS			
	50-1860-224BL-WB	Half Pin, 6.0/220/40mm, Blunt Self Tapping, QC, SS			
	50-1860-253BL-WB	Half Pin, 6.0/250/30mm, Blunt Self Tapping, QC, SS			
50-1860-254BL-WB	Half Pin, 6.0/250/40mm, Blunt Self Tapping, QC, SS				

DELIVERED GOODS FORM (CONTINUED)



SELF DRILLING HA HALF PINS - STERILE



ITEM #	DESCRIPTION	QTY	UNIT PRICE	TOTAL
11-701-360120S-0	HA Half Pin, 6mm, 120X30, Self Drilling			
11-701-360150S-0	HA Half Pin, 6mm, 150X40, Self Drilling			
11-701-256150S-0	HA Half Pin, 6mm, 150X44, Self Drilling			
11-701-360180S-0	HA Half Pin, 6mm, 180X50, Self Drilling			

SELF DRILLING HALF PINS HA EXTENDED ONTO SHAFT - STERILE



ITEM #	DESCRIPTION	QTY	UNIT PRICE	TOTAL
11-701-360148S-0	HA Half Pin, Extended Coating, 6mm, 150X30, Self Drilling			
11-701-360178S-0	HA Half Pin, Extended Coating, 6mm, 180X35, Self Drilling			
11-701-360198S-0	HA Half Pin, Extended Coating, 6mm, 200X40, Self Drilling			

HA HALF PINS - STERILE (DRILLING NEEDED)



ITEM #	DESCRIPTION	QTY	UNIT PRICE	TOTAL
11-701-156150S-0	HA Half Pin, 6mm, 150X40			
11-701-156180S-0	HA Half Pin, 6mm, 180X50			

ITEM #	DESCRIPTION	QTY	UNIT PRICE	TOTAL
51-701-401335S-0*	Drill Bit For HA Half Pins, Long - Sterile			
51-701-401325S-0*	Drill Bit For HA Half Pins, Short - Sterile			
00-6200-32-WB	AO Drill Bit 3.2 x 200mm			
00-6200-48-WB	AO Drill Bit 4.8 x 200mm			



ITEM #	DESCRIPTION	QTY	UNIT PRICE	TOTAL
00-STID-00-WB-NS	Strut ID Clips - Non-Sterile			
50-1015-00-WBNS	Walking Foot Attachment - Non-Sterile			
50-60PC-06NS	Half Pin Covers, 6mm (6 pack) - Non-Sterile			
50-16WC-06NS	1.6 Wire Covers (6 pack) - Non-Sterile			
50-20WC-06NS	2.0 Wire Covers (6 pack) - Non-Sterile			
000502	Sponge Clips (12 pack) - Non-Sterile			



*These components are provided sterile packed and are intended to be used with HA Half Pins.

DELIVERED GOODS FORM (CONTINUED)

ADDITIONAL SINGLE-USE STERILE OFFERINGS

ITEM #	DESCRIPTION	QTY	UNIT PRICE	TOTAL
950S	Pin Site Sponge Sterile Pack (30 Sponges)			
51-701-601306G-0*	6mm AO Quick Release Adaptor			
51-700-003220G-0	AO Drill Bit 3.2 x 200mm			
51-700-004820G-0	AO Drill Bit 4.8 x 200mm			
11-700-105201T-0	Standard Nut			
11-700-115306T-0	Shoulder Bolt, 6mm			
11-700-115308T-0	Shoulder Bolt, 8mm			
00-STID-00-WBSP	Strut ID Kit			
50-60PC-03SP	Half Pin Covers, 6mm			
50-20WC-02SP	Wire Cover, 2.0			
50-16WC-02SP	Wire Cover, 1.6			
50-1062-00S-WBSP	Wire Stopper Washer, SS			
50-1052-03-WBSP	Long Nut (12.8mm)			
50-1051-01-WBSP	Locking Washer			
50-1056-60-WBSP	Pin Sleeve and Set Screw			
IVCD-15	Lifesaver® Ag – 1" Diameter with 1.5mm ID (for Wires)			
IVCD-40	Lifesaver® Ag – 1" Diameter with 4.0mm ID (for Half Pins)			



*These components are provided sterile packed and are intended to be used with HA Half Pins.