

SMART

Correction™

EXTERNAL FIXATOR SYSTEM

Strut Exchange

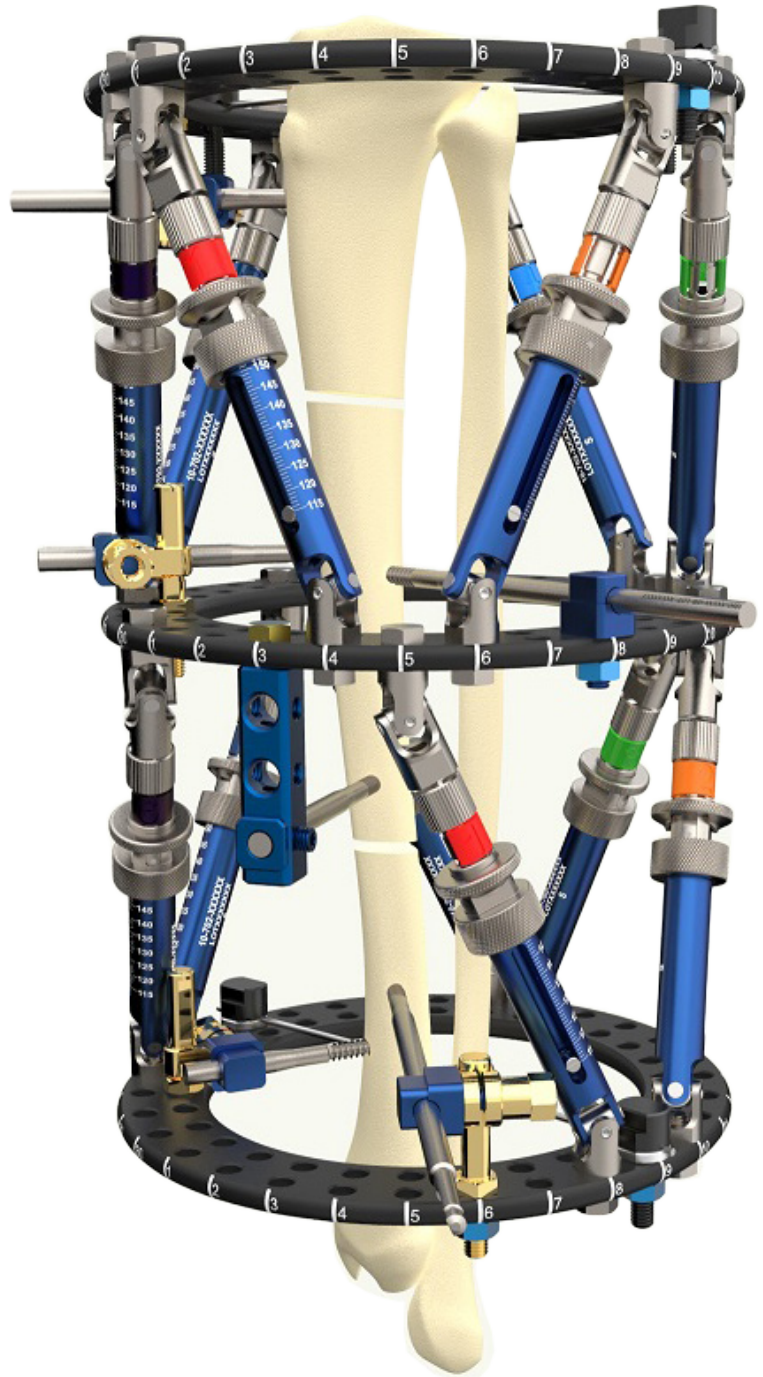

COMPONENTS NEEDED

1. Advanced Clamps (x2)
2. 10mm Wrench (x2)
3. Threaded Rod: 60-300mm (x1)
4. Nuts (x2)
5. Struts
6. Shoulder Bolts: 6/8mm (x2 per Strut exchange)

Alternative Components:
Advanced Clamp Posts (x2)
Standard Pin Clamps (x2)
Nuts (x2)

SURGICAL TECHNIQUE: STRUT EXCHANGE

A Strut exchange may need to be performed during the course of treatment. Additionally, multiple Strut exchanges may be necessary during a single event. In order to bridge the frame in the area of the Strut exchange, place a temporary support to prevent loss of construct stability.

Insert Clamps (Proximal Ring)

- 1 Insert the Advanced Pin Clamp into the proximal Ring as close to the original Strut as possible (Fig. 1).



Insert Clamps (Distal Ring)

- 1 Repeat this step on the distal Ring (Fig. 2).
Note: A Standard Pin Clamp used in conjunction with an Advanced Clamp Post can be used in place of an Advanced Pin Clamp (Fig. 3). The same type of clamp should be used for the proximal and distal Ring during Strut exchange.

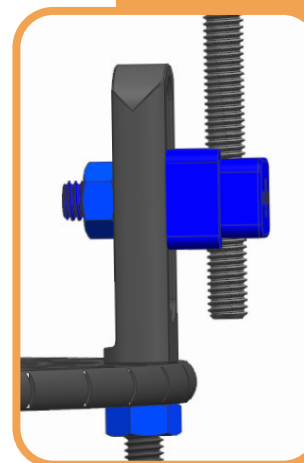

Fig. 3

Insert Threaded Rod

- 3 Insert the Threaded Rod through both Advanced Pin Clamps (proximally and distally). Tighten the clamps (Fig. 4).



Fig. 4

SURGICAL TECHNIQUE: **STRUT EXCHANGE**, (CONT)

Loosen Bolts

- 4 Loosen the Shoulder Bolts on both ends of the Strut to be exchanged (Fig. 5).

Warning: These Shoulder Bolts should not be reused. New Shoulder Bolts should be utilized when replacing Struts.

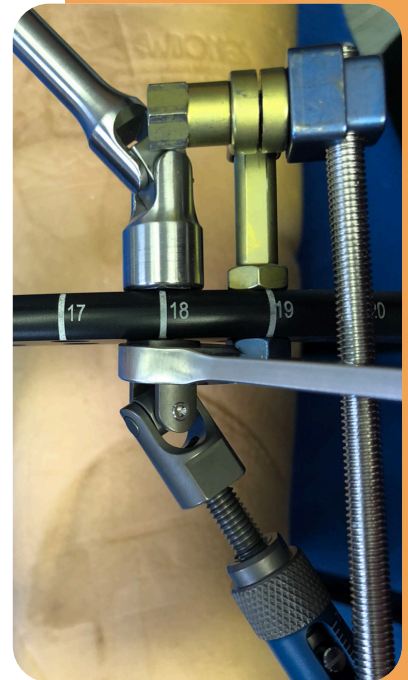

Fig. 5

Remove Original Strut

- 5 Ensure the Strut removed matches prescription (Fig. 6, 7).



Fig. 6

Place New Strut

- 6 Strut should be placed in the same hole locations as the original Strut. Strut length should match the designated length on the patient prescription (Fig. 7).

Warning: New Shoulder Bolts should be utilized during Strut replacement.



Fig. 7

SURGICAL TECHNIQUE: **STRUT EXCHANGE**, (CONT)

Transfer Strut ID Clip

- 7 Transfer the Strut ID Clip onto the new Strut.

Final Tightening

- 8 Perform final tightening on the new Strut and Shoulder Bolts using two 10mm Hex Bolt Wrenches. An 8Nm Torque Limiting Ratchet Wrench is available for Shoulder Bolt tightening.

Remove Temporary Support

- 9 Once the new Strut is securely in place, remove the Advanced Pin Clamps or Advanced Clamp Posts with Standard Pin Clamps and Threaded Rod.



WishBoneMedical.com

100 Capital Drive
Warsaw, IN 46582
+1-574-306-4006

All trademarks here in are the property of WishBone Medical, Inc. or its subsidiaries unless otherwise indicated. This material is intended for the sole use and benefit of Health Care Professionals and the WishBone Medical Sales Force. It is not to be redistributed, duplicated or disclosed without the express written consent of WishBone Medical.

Caution: Federal law restricts this device to sale by or on the order of a physician.

The MR environment presents risks to patients with metal implants. Physicians should consider the risks when recommending MR imaging for patients with metal implants.

The Smart Correction System components have not been evaluated for safety in the MR environment. They have not been tested for heating or unwanted movement in the MR environment. The safety of the Smart Correction System in the MR environment is unknown. Performing an MR exam on a person who has this medical device may result in injury or device malfunction.

For product information, including indications, contraindications, warnings, precautions and potential adverse effects, visit WishBone Medical's Instructions for Use page online: www.WishBoneMedical.com/IFU.