

DELIVERED GOODS FORM

PATIENT INFORMATION

Hospital: _____

Account Number: _____

Surgery Date: _____ OR #: _____

Surgeon: _____

Procedure: _____

Received by: _____

Rep Name & Company: _____

ITEM #	COLOR	DESCRIPTION	QTY	UNIT PRICE	TOTAL
FULL RINGS	10-700-070060A-0	BLACK			
	10-700-07006BA-0	BLUE			
	10-700-07006UA-0	PURPLE			
	10-700-07006PA-0	PINK	Dual Hole Full Ring, 70mm ID, Aluminum -NS		
	10-700-07006RA-0	RED			
	10-700-07006GA-0	GREEN			
	10-700-07006AA-0	GOLD			
	10-700-080060A-0	BLACK			
	10-700-08006BA-0	BLUE			
	10-700-08006UA-0	PURPLE			
	10-700-08006PA-0	PINK	Dual Hole Full Ring, 80mm ID, Aluminum -NS		
	10-700-08006RA-0	RED			
10-700-08006GA-0	GREEN				
10-700-08006AA-0	GOLD				
10-700-090060A-0	BLACK				
10-700-09006BA-0	BLUE				
10-700-09006UA-0	PURPLE				
10-700-09006PA-0	PINK	Dual Hole Full Ring, 90mm ID, Aluminum -NS			
10-700-09006RA-0	RED				
10-700-09006GA-0	GREEN				
10-700-09006AA-0	GOLD				
50-1012-10A-WB	BLACK				
10-700-10506BA-0	BLUE				
10-700-10506UA-0	PURPLE				
10-700-10506PA-0	PINK	Dual Hole Full Ring, 105mm ID, Aluminum -NS			
10-700-10506RA-0	RED				
10-700-10506GA-0	GREEN				
10-700-10506AA-0	GOLD				
50-1012-12A-WB	BLACK				
10-700-12006BA-0	BLUE				
10-700-12006UA-0	PURPLE				
10-700-12006PA-0	PINK	Dual Hole Full Ring, 120mm ID, Aluminum -NS			
10-700-12006RA-0	RED				
10-700-12006GA-0	GREEN				
10-700-12006AA-0	GOLD				

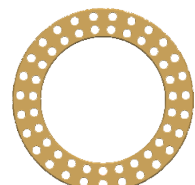
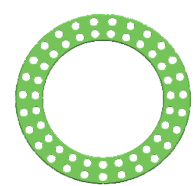
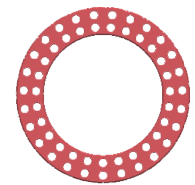
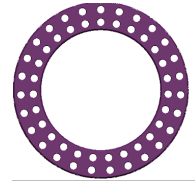
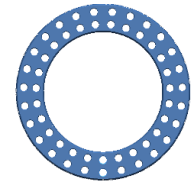
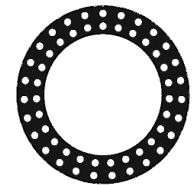

DELIVERED GOODS FORM (CONTINUED)

FULL RINGS

ITEM #	COLOR	DESCRIPTION	QTY	UNIT PRICE	TOTAL
50-1012-13A-WB	BLACK	Dual Hole Full Ring, 135mm ID, Aluminum -NS			
10-700-13506BA-0	BLUE				
10-700-13506UA-0	PURPLE				
10-700-13506PA-0	PINK				
10-700-13506RA-0	RED				
10-700-13506GA-0	GREEN				
10-700-13506AA-0	GOLD				
50-1012-15A-WB	BLACK	Dual Hole Full Ring, 150mm ID, Aluminum -NS			
10-700-15006BA-0	BLUE				
10-700-15006UA-0	PURPLE				
10-700-15006PA-0	PINK				
10-700-15006RA-0	RED				
10-700-15006GA-0	GREEN				
10-700-15006AA-0	GOLD				
50-1012-16A-WB	BLACK	Dual Hole Full Ring, 165mm ID, Aluminum -NS			
10-700-16506BA-0	BLUE				
10-700-16506UA-0	PURPLE				
10-700-16506PA-0	PINK				
10-700-16506RA-0	RED				
10-700-16506GA-0	GREEN				
10-700-16506AA-0	GOLD				
50-1012-18A-WB	BLACK	Dual Hole Full Ring, 180mm ID, Aluminum -NS			
10-700-18006BA-0	BLUE				
10-700-18006UA-0	PURPLE				
10-700-18006PA-0	PINK				
10-700-18006RA-0	RED				
10-700-18006GA-0	GREEN				
10-700-18006AA-0	GOLD				
50-1012-19A-WB	BLACK	Dual Hole Full Ring, 195mm ID, Aluminum -NS			
10-700-19506BA-0	BLUE				
10-700-19506UA-0	PURPLE				
10-700-19506PA-0	PINK				
10-700-19506RA-0	RED				
10-700-19506GA-0	GREEN				
10-700-19506AA-0	GOLD				
50-1012-21A-WB	BLACK	Dual Hole Full Ring, 210mm ID, Aluminum -NS			
10-700-21006BA-0	BLUE				
10-700-21006UA-0	PURPLE				
10-700-21006PA-0	PINK				
10-700-21006RA-0	RED				
10-700-21006GA-0	GREEN				
10-700-21006AA-0	GOLD				

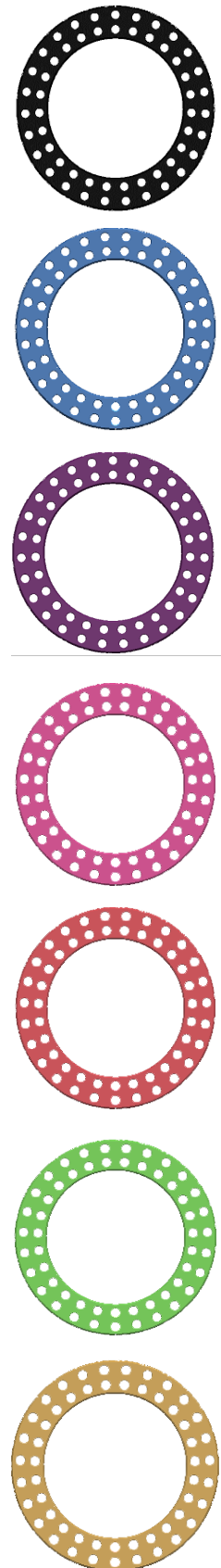

NS signifies Non Sterile.

DELIVERED GOODS FORM (CONTINUED)

FULL RINGS

ITEM #	COLOR	DESCRIPTION	QTY	UNIT PRICE	TOTAL
50-1012-22A-WB	BLACK	Dual Hole Full Ring, 225mm ID, Aluminum -NS			
10-700-22506BA-0	BLUE				
10-700-22506UA-0	PURPLE				
10-700-22506PA-0	PINK				
10-700-22506RA-0	RED				
10-700-22506GA-0	GREEN				
10-700-22506AA-0	GOLD				
50-1012-24A-WB	BLACK	Dual Hole Full Ring, 240mm ID, Aluminum -NS			
10-700-24006BA-0	BLUE				
10-700-24006UA-0	PURPLE				
10-700-24006PA-0	PINK				
10-700-24006RA-0	RED				
10-700-24006GA-0	GREEN				
10-700-24006AA-0	GOLD				

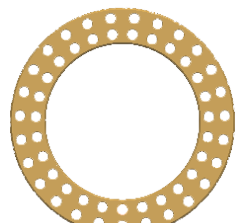
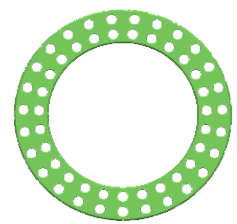
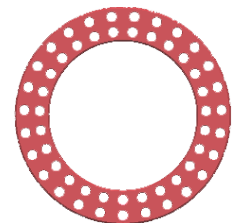
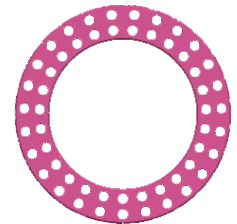
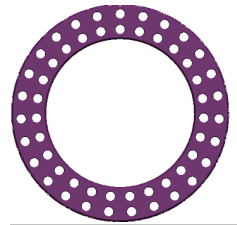
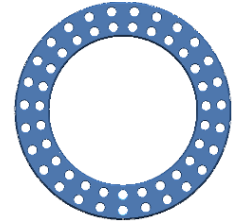
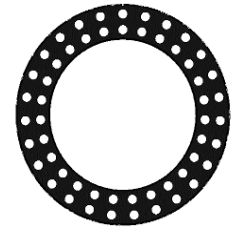

NS signifies Non Sterile.

DELIVERED GOODS FORM (CONTINUED)

2/3 RINGS

ITEM #	COLOR	DESCRIPTION	QTY	UNIT PRICE	TOTAL
10-700-070280A-0	BLACK				
10-700-07028BA-0	BLUE				
10-700-07028UA-0	PURPLE				
10-700-07028PA-0	PINK	Dual Hole 2/3 Ring, 70mm ID, Aluminum -NS			
10-700-07028RA-0	RED				
10-700-07028GA-0	GREEN				
10-700-07028AA-0	GOLD				
10-700-080280A-0	BLACK				
10-700-08028BA-0	BLUE				
10-700-08028UA-0	PURPLE				
10-700-08028PA-0	PINK	Dual Hole 2/3 Ring, 80mm ID, Aluminum -NS			
10-700-08028RA-0	RED				
10-700-08028GA-0	GREEN				
10-700-08028AA-0	GOLD				
10-700-090280A-0	BLACK				
10-700-09028BA-0	BLUE				
10-700-09028UA-0	PURPLE				
10-700-09028PA-0	PINK	Dual Hole 2/3 Ring, 90mm ID, Aluminum -NS			
10-700-09028RA-0	RED				
10-700-09028GA-0	GREEN				
10-700-09028AA-0	GOLD				
50-1017-10A-WB	BLACK				
10-700-10528BA-0	BLUE				
10-700-10528UA-0	PURPLE				
10-700-10528PA-0	PINK	Dual Hole 2/3 Ring, 105mm ID, Aluminum -NS			
10-700-10528RA-0	RED				
10-700-10528GA-0	GREEN				
10-700-10528AA-0	GOLD				
50-1017-12A-WB	BLACK				
10-700-12028BA-0	BLUE				
10-700-12028UA-0	PURPLE				
10-700-12028PA-0	PINK	Dual Hole 2/3 Ring, 120mm ID, Aluminum -NS			
10-700-12028RA-0	RED				
10-700-12028GA-0	GREEN				
10-700-12028AA-0	GOLD				
50-1017-13A-WB	BLACK				
10-700-13528BA-0	BLUE				
10-700-13528UA-0	PURPLE				
10-700-13528PA-0	PINK	Dual Hole 2/3 Ring, 135mm ID, Aluminum -NS			
10-700-13528RA-0	RED				
10-700-13528GA-0	GREEN				
10-700-13528AA-0	GOLD				

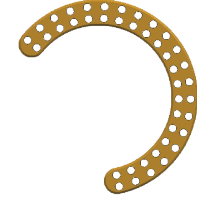
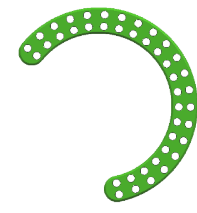
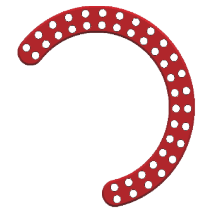
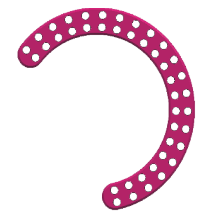
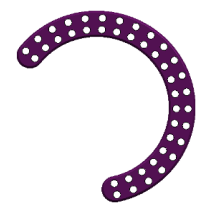
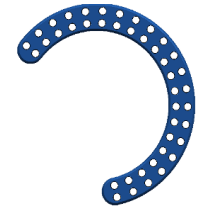
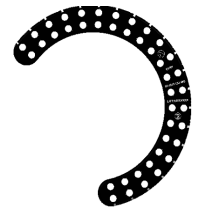

NS signifies Non Sterile.

DELIVERED GOODS FORM (CONTINUED)

2/3 RINGS

ITEM #	COLOR	DESCRIPTION	QTY	UNIT PRICE	TOTAL
50-1017-15A-WB	BLACK	Dual Hole 2/3 Ring, 150mm ID, Aluminum -NS			
10-700-15028BA-0	BLUE				
10-700-15028UA-0	PURPLE				
10-700-15028PA-0	PINK				
10-700-15028RA-0	RED				
10-700-15028GA-0	GREEN				
10-700-15028AA-0	GOLD				
50-1017-16A-WB	BLACK	Dual Hole 2/3 Ring, 165mm ID, Aluminum -NS			
10-700-16528BA-0	BLUE				
10-700-16528UA-0	PURPLE				
10-700-16528PA-0	PINK				
10-700-16528RA-0	RED				
10-700-16528GA-0	GREEN				
10-700-16528AA-0	GOLD				
50-1017-18A-WB	BLACK	Dual Hole 2/3 Ring, 180mm ID, Aluminum -NS			
10-700-18028BA-0	BLUE				
10-700-18028UA-0	PURPLE				
10-700-18028PA-0	PINK				
10-700-18028RA-0	RED				
10-700-18028GA-0	GREEN				
10-700-18028AA-0	GOLD				
50-1017-19A-WB	BLACK	Dual Hole 2/3 Ring, 195mm ID, Aluminum -NS			
10-700-19528BA-0	BLUE				
10-700-19528UA-0	PURPLE				
10-700-19528PA-0	PINK				
10-700-19528RA-0	RED				
10-700-19528GA-0	GREEN				
10-700-19528AA-0	GOLD				
50-1017-21A-WB	BLACK	Dual Hole 2/3 Ring, 210mm ID, Aluminum -NS			
10-700-21028BA-0	BLUE				
10-700-21028UA-0	PURPLE				
10-700-21028PA-0	PINK				
10-700-21028RA-0	RED				
10-700-21028GA-0	GREEN				
10-700-21028AA-0	GOLD				
50-1017-22A-WB	BLACK	Dual Hole 2/3 Ring, 225mm ID, Aluminum -NS			
10-700-22528BA-0	BLUE				
10-700-22528UA-0	PURPLE				
10-700-22528PA-0	PINK				
10-700-22528RA-0	RED				
10-700-22528GA-0	GREEN				
10-700-22528AA-0	GOLD				

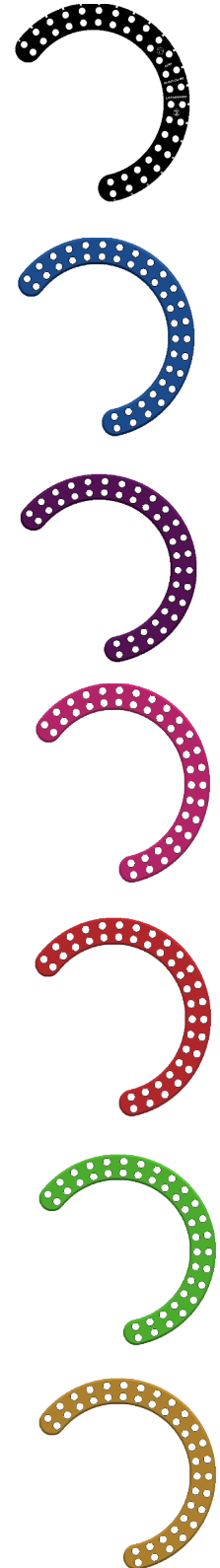

NS signifies Non Sterile.

DELIVERED GOODS FORM (CONTINUED)

2/3 RINGS

ITEM #	COLOR	DESCRIPTION	QTY	UNIT PRICE	TOTAL
50-1017-24A-WB	BLACK	Dual Hole 2/3 Ring, 240mm ID, Aluminum -NS			
10-700-24028BA-0	BLUE				
10-700-24028UA-0	PURPLE				
10-700-24028PA-0	PINK				
10-700-24028RA-0	RED				
10-700-24028GA-0	GREEN				
10-700-24028AA-0	GOLD				

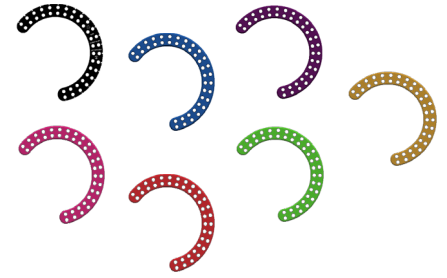

1/2 RINGS

ITEM #	COLOR	DESCRIPTION	QTY	UNIT PRICE	TOTAL
10-700-070180A-0	BLACK	Dual Hole 1/2 Ring, 70mm ID, Aluminum - NS			
10-700-07018BA-0	BLUE				
10-700-07018UA-0	PURPLE				
10-700-07018PA-0	PINK				
10-700-07018RA-0	RED				
10-700-07018GA-0	GREEN				
10-700-07018AA-0	GOLD				
10-700-080180A-0	BLACK	Dual Hole 1/2 Ring, 80mm ID, Aluminum - NS			
10-700-08018BA-0	BLUE				
10-700-08018UA-0	PURPLE				
10-700-08018PA-0	PINK				
10-700-08018RA-0	RED				
10-700-08018GA-0	GREEN				
10-700-08018AA-0	GOLD				
10-700-090180A-0	BLACK	Dual Hole 1/2 Ring, 90mm ID, Aluminum - NS			
10-700-09018BA-0	BLUE				
10-700-09018UA-0	PURPLE				
10-700-09018PA-0	PINK				
10-700-09018RA-0	RED				
10-700-09018GA-0	GREEN				
10-700-09018AA-0	GOLD				
10-700-120180A-0	BLACK	Dual Hole 1/2 Ring, 120mm ID, Aluminum - NS			
10-700-12018BA-0	BLUE				
10-700-12018UA-0	PURPLE				
10-700-12018PA-0	PINK				
10-700-12018RA-0	RED				
10-700-12018GA-0	GREEN				
10-700-12018AA-0	GOLD				
10-700-150180A-0	BLACK	Dual Hole 1/2 Ring, 150mm ID, Aluminum - NS			
10-700-15018BA-0	BLUE				
10-700-15018UA-0	PURPLE				
10-700-15018PA-0	PINK				
10-700-15018RA-0	RED				
10-700-15018GA-0	GREEN				
10-700-15018AA-0	GOLD				

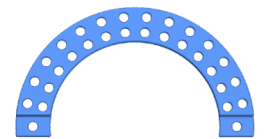

NS signifies Non Sterile.

DELIVERED GOODS FORM (CONTINUED)

1/2 RINGS	ITEM #	COLOR	DESCRIPTION	QTY	UNIT PRICE	TOTAL	
	10-700-180180A-0	BLACK	Dual Hole 1/2 Ring, 180mm ID, Aluminum - NS				
	10-700-18018BA-0	BLUE					
	10-700-18018UA-0	PURPLE					
	10-700-18018PA-0	PINK					
	10-700-18018RA-0	RED					
	10-700-18018GA-0	GREEN					
	10-700-18018AA-0	GOLD					
	10-700-210180A-0	BLACK		Dual Hole 1/2 Ring, 210mm ID, Aluminum - NS			
	10-700-21018BA-0	BLUE					
10-700-21018UA-0	PURPLE						
10-700-21018PA-0	PINK						
10-700-21018RA-0	RED						
10-700-21018GA-0	GREEN						
10-700-21018AA-0	GOLD						

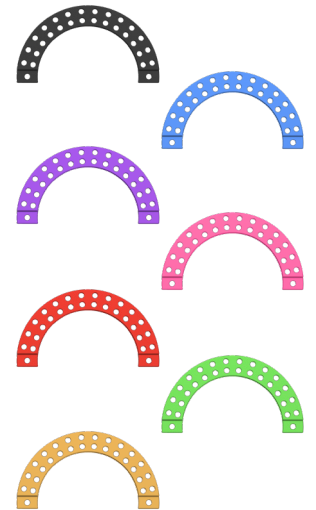

1/3 RINGS	ITEM #	COLOR	DESCRIPTION	QTY	UNIT PRICE	TOTAL
	50-1018-10A-WB	BLACK	Dual Hole 1/3 Ring, 105mm ID, Aluminum -NS			
	10-700-10538BA-0	BLUE				
	10-700-10538UA-0	PURPLE				
	10-700-10538PA-0	PINK				
	10-700-10538RA-0	RED				
	10-700-10538GA-0	GREEN				
	10-700-10538AA-0	GOLD				
	50-1018-12A-WB	BLACK	Dual Hole 1/3 Ring, 120mm ID, Aluminum -NS			
	10-700-12038BA-0	BLUE				
10-700-12038UA-0	PURPLE					
10-700-10538PA-0	PINK					
10-700-12038RA-0	RED					
10-700-12038GA-0	GREEN					
10-700-12038AA-0	GOLD					
50-1018-13A-WB	BLACK	Dual Hole 1/3 Ring, 135mm ID, Aluminum -NS				
10-700-13538BA-0	BLUE					
10-700-13538UA-0	PURPLE					
10-700-13538PA-0	PINK					
10-700-13538RA-0	RED					
10-700-13538GA-0	GREEN					
10-700-13538AA-0	GOLD					

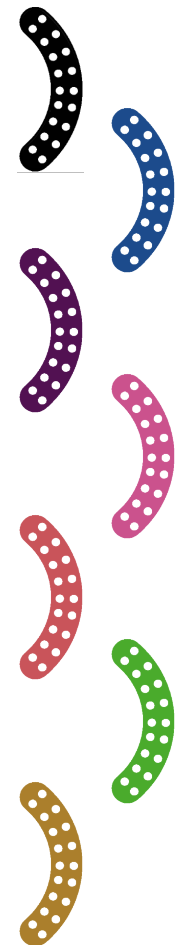

NS signifies Non Sterile.

DELIVERED GOODS FORM (CONTINUED)

1/3 RINGS

ITEM #	COLOR	DESCRIPTION	QTY	UNIT PRICE	TOTAL
50-1018-15A-WB	BLACK	Dual Hole 1/3 Ring, 150mm ID, Aluminum -NS			
10-700-15038BA-0	BLUE				
10-700-15038UA-0	PURPLE				
10-700-15038PA-0	PINK				
10-700-15038RA-0	RED				
10-700-15038GA-0	GREEN				
10-700-15038AA-0	GOLD				
50-1018-16A-WB	BLACK	Dual Hole 1/3 Ring, 165mm ID, Aluminum -NS			
10-700-16538BA-0	BLUE				
10-700-16538UA-0	PURPLE				
10-700-16538PA-0	PINK				
10-700-16538RA-0	RED				
10-700-16538GA-0	GREEN				
10-700-16538AA-0	GOLD				
50-1018-18A-WB	BLACK	Dual Hole 1/3 Ring, 180mm ID, Aluminum -NS			
10-700-18038BA-0	BLUE				
10-700-18038UA-0	PURPLE				
10-700-18038PA-0	PINK				
10-700-18038RA-0	RED				
10-700-18038GA-0	GREEN				
10-700-18038AA-0	GOLD				
50-1018-19A-WBNS	BLACK	Dual Hole 1/3 Ring, 195mm ID, Aluminum -NS			
50-1018-19A-WB	BLUE				
10-700-19538BA-0	PURPLE				
10-700-19538UA-0	PINK				
10-700-19538PA-0	RED				
10-700-19538RA-0	GREEN				
10-700-19538GA-0	GOLD				
10-700-19538AA-0	BLACK	Dual Hole 1/3 Ring, 210mm ID, Aluminum -NS			
50-1018-21A-WB	BLUE				
10-700-21038BA-0	PURPLE				
10-700-21038UA-0	PINK				
10-700-21038PA-0	RED				
10-700-21038RA-0	GREEN				
10-700-21038GA-0	GOLD				
50-1018-22A-WB	BLACK	Dual Hole 1/3 Ring, 225mm ID, Aluminum -NS			
10-700-22538BA-0	BLUE				
10-700-22538UA-0	PURPLE				
10-700-22538PA-0	PINK				
10-700-22538RA-0	RED				
10-700-22538GA-0	GREEN				
10-700-22538AA-0	GOLD				

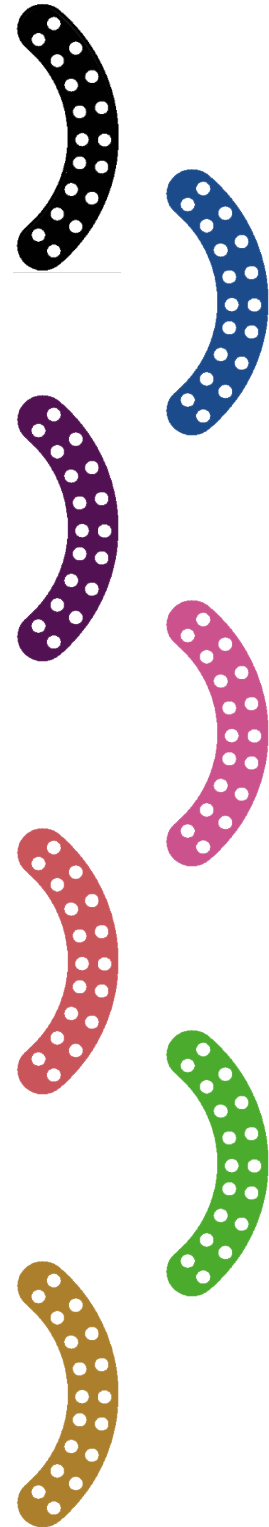

NS signifies Non Sterile.

DELIVERED GOODS FORM (CONTINUED)

1/3 RINGS

ITEM #	COLOR	DESCRIPTION	QTY	UNIT PRICE	TOTAL
50-1018-24A-WB	BLACK	Dual Hole 1/3 Ring, 240mm ID, Aluminum -NS			
10-700-24038BA-0	BLUE				
10-700-24038UA-0	PURPLE				
10-700-24038PA-0	PINK				
10-700-24038RA-0	RED				
10-700-24038GA-0	GREEN				
10-700-24038AA-0	GOLD				

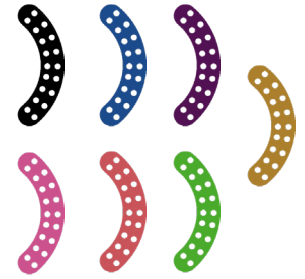

FOOT RINGS

ITEM #	COLOR	DESCRIPTION	QTY	UNIT PRICE	TOTAL
10-700-070480A-0	BLACK	Dual Hole Foot Ring, 70mm ID, Aluminum -NS			
10-700-07048BA-0	BLUE				
10-700-07048UA-0	PURPLE				
10-700-07048PA-0	PINK				
10-700-07048RA-0	RED				
10-700-07048GA-0	GREEN				
10-700-07048AA-0	GOLD				
10-700-080480A-0	BLACK	Dual Hole Foot Ring, 80mm ID, Aluminum -NS			
10-700-08048BA-0	BLUE				
10-700-08048UA-0	PURPLE				
10-700-08048PA-0	PINK				
10-700-08048RA-0	RED				
10-700-08048GA-0	GREEN				
10-700-08048AA-0	GOLD				
10-700-090480A-0	BLACK	Dual Hole Foot Ring, 90mm ID, Aluminum -NS			
10-700-09048BA-0	BLUE				
10-700-09048UA-0	PURPLE				
10-700-09048PA-0	PINK				
10-700-09048RA-0	RED				
10-700-09048GA-0	GREEN				
10-700-09048AA-0	GOLD				
10-700-120580A-0	BLACK	Dual Hole Foot Ring, 120mm ID, Aluminum - NS			
10-700-12048BA-0	BLUE				
10-700-12048UA-0	PURPLE				
10-700-12048PA-0	PINK				
10-700-12048RA-0	RED				
10-700-12048GA-0	GREEN				
10-700-12048AA-0	GOLD				
10-700-150480A-0	BLACK	Dual Hole Foot Ring, 150mm ID, Aluminum - NS			
10-700-15048BA-0	BLUE				
10-700-15048UA-0	PURPLE				
10-700-15048PA-0	PINK				
10-700-15048RA-0	RED				
10-700-15048GA-0	GREEN				
10-700-15048AA-0	GOLD				



NS signifies Non Sterile.

DELIVERED GOODS FORM (CONTINUED)

FOOT RINGS

ITEM #	COLOR	DESCRIPTION	QTY	UNIT PRICE	TOTAL
10-700-180480A-0	BLACK	Dual Hole Foot Ring, 180mm ID, Aluminum - NS			
10-700-18048BA-0	BLUE				
10-700-18048UA-0	PURPLE				
10-700-18048PA-0	PINK				
10-700-18048RA-0	RED				
10-700-18048GA-0	GREEN				
10-700-18048AA-0	GOLD				
10-700-210480A-0	BLACK		Dual Hole Foot Ring, 210mm ID, Aluminum -NS		
10-700-21048AA-0	BLUE				
10-700-21048BA-0	PURPLE				
10-700-21048GA-0	PINK				
10-700-21048PA-0	RED				
10-700-21048RA-0	GREEN				
10-700-21048UA-0	GOLD				

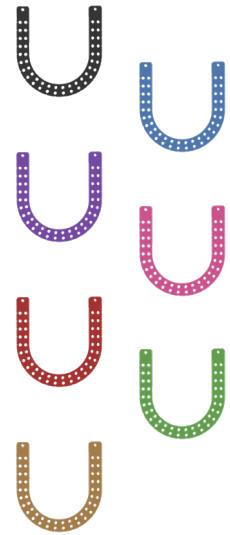

SHORT FOOT RINGS

ITEM #	COLOR	DESCRIPTION	QTY	UNIT PRICE	TOTAL
10-700-070580A-0	BLACK	Dual Hole Foot Ring Short, 70mm ID, Aluminum -NS			
10-700-07058BA-0	BLUE				
10-700-07058UA-0	PURPLE				
10-700-07058PA-0	PINK				
10-700-07058RA-0	RED				
10-700-07058GA-0	GREEN				
10-700-07058AA-0	GOLD	Dual Hole Foot Ring Short, 80mm ID, Aluminum -NS			
10-700-080580A-0	BLACK				
10-700-08058BA-0	BLUE				
10-700-08058UA-0	PURPLE				
10-700-08058PA-0	PINK				
10-700-08058RA-0	RED				
10-700-08058GA-0	GREEN	Dual Hole Foot Ring Short, 90mm ID, Aluminum -NS			
10-700-08058AA-0	GOLD				
10-700-090580A-0	BLACK				
10-700-09058BA-0	BLUE				
10-700-09058UA-0	PURPLE				
10-700-09058PA-0	PINK				
10-700-09058RA-0	RED	Dual Hole Foot Ring Short, 120mm ID, Aluminum -NS			
10-700-09058GA-0	GREEN				
10-700-09058AA-0	GOLD				
10-700-120580A-0	BLACK				
10-700-12058BA-0	BLUE				
10-700-12058UA-0	PURPLE				
10-700-12058PA-0	PINK				
10-700-12058RA-0	RED				
10-700-12058GA-0	GREEN				
10-700-12058AA-0	GOLD				



NS signifies Non Sterile.

DELIVERED GOODS FORM (CONTINUED)

SHORT FOOT RINGS

ITEM #	COLOR	DESCRIPTION	QTY	UNIT PRICE	TOTAL	
10-700-150580A-0	BLACK	Dual Hole Foot Ring Short, 150mm ID, Aluminum -NS				
10-700-15058BA-0	BLUE					
10-700-15058UA-0	PURPLE					
10-700-15058PA-0	PINK					
10-700-15058RA-0	RED					
10-700-15058GA-0	GREEN					
10-700-15058AA-0	GOLD					
10-700-180580A-0	BLACK		Dual Hole Foot Ring Short, 180mm ID, Aluminum -NS			
10-700-18058BA-0	BLUE					
10-700-18058UA-0	PURPLE					
10-700-18058PA-0	PINK					
10-700-18058RA-0	RED					
10-700-18058GA-0	GREEN					
10-700-18058AA-0	GOLD					
10-700-210580A-0	BLACK	Dual Hole Foot Ring Short, 210mm ID, Aluminum -NS				
10-700-21058BA-0	BLUE					
10-700-21058UA-0	PURPLE					
10-700-21058PA-0	PINK					
10-700-21058RA-0	RED					
10-700-21058GA-0	GREEN					
10-700-21058AA-0	GOLD					

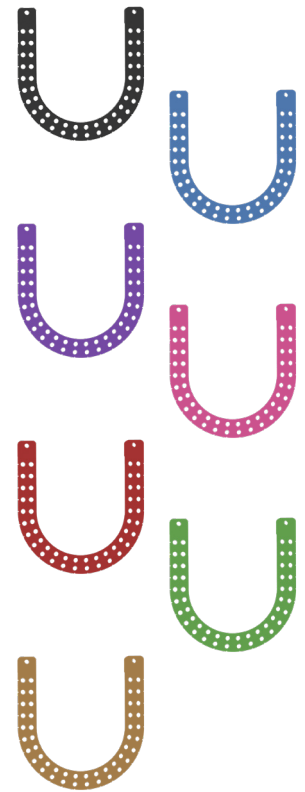

ITEM #	DESCRIPTION	QTY	UNIT PRICE	TOTAL
50-1018-00A-WB	Dual Hole 1/3 - 2/3 Ring Connector			



DUAL JOINT STRUTS

ITEM #	DESCRIPTION	QTY	UNIT PRICE	TOTAL
10-702-080095-0	Dual Joint Express Strut, XXShort			
10-702-095115-0	Dual Joint Express Strut, XShort			
10-702-115150-0	Dual Joint Express Strut, Short			
10-702-140200-0	Dual Joint Express Strut, Medium			
10-702-190300-0	Dual Joint Express Strut, Long			
50-1031-00-WB	Dual Joint Standard Strut, XXShort			
50-1031-01-WB	Dual Joint Standard Strut, XShort			
50-1031-02-WB	Dual Joint Standard Strut, Short			
50-1031-03-WB	Dual Joint Standard Strut, Medium			
50-1031-04-WB	Dual Joint Standard Strut, Long			



NS signifies Non Sterile.

DELIVERED GOODS FORM (CONTINUED)

CLAMPS

ITEM #	DESCRIPTION	QTY	UNIT PRICE	TOTAL
50-1041-00-WB	Standard Wire Clamp			
50-1042-30-WB	Advanced Pin Clamp			
720-000005T	Advanced Pin Clamp V2			
50-1042-00-WB	Standard Pin Clamp			
720-000004T	Standard Pin Clamp V2			
50-1043-01-WB	Advanced Clamp Post - Small, 26mm			
50-1043-02-WB	Advanced Clamp Post - Large, 42mm			
50-1044-00-WB	Side Load Wire Clamp			



CUBES

ITEM #	DESCRIPTION	QTY	UNIT PRICE	TOTAL
50-1056-01-WB	Cube, 1-Hole			
50-1056-02-WB	Cube, 2-Hole			
50-1056-03-WB	Cube, 3-Hole			
50-1056-04-WB	Cube, 4-Hole			
50-1056-05-WB	Cube, 5-Hole			
50-1058-06-WB	Set Screw, 6mm			
50-1056-60-WB	Pin Sleeve for Cube, 6mm			

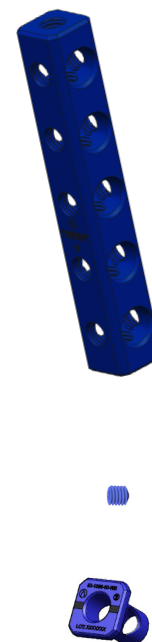

NS signifies Non Sterile.

DELIVERED GOODS FORM (CONTINUED)

NUTS, BOLTS, WASHERS

ITEM #	DESCRIPTION	QTY	UNIT PRICE	TOTAL
50-1052-01-WB	Standard Nut			
50-1052-03-WB	Long Nut (12.8mm)			
50-1053-12-WB	Connection Bolt, Short, 12mm			
50-1053-16-WB	Connection Bolt, Medium, 16mm			
50-1053-20-WB	Connection Bolt, Long, 20mm			
50-1153-06-WB	Shoulder Bolt, 6mm			
50-1153-08-WB	Shoulder Bolt, 8mm			
50-1051-00-WB	Washer			
50-1051-01-WB	Locking Washer			

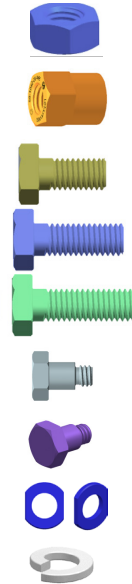

ITEM #	DESCRIPTION	QTY	UNIT PRICE	TOTAL
50-1054-20-WB	Dual Rod Connector, Short			
50-1054-40-WB	Dual Rod Connector, Medium			
50-1054-60-WB	Dual Rod Connector, Long			



THREADED RODS

ITEM #	DESCRIPTION	QTY	UNIT PRICE	TOTAL
50-1057-60S-WB	Threaded Rod, 60mm Length, SS			
50-1057-80S-WB	Threaded Rod, 80mm Length, SS			
50-1057-100S-WB	Threaded Rod, 100mm Length, SS			
50-1057-120S-WB	Threaded Rod, 120mm Length, SS			
50-1057-150S-WB	Threaded Rod, 150mm Length, SS			
50-1057-200S-WB	Threaded Rod, 200mm Length, SS			
50-1057-250S-WB	Threaded Rod, 250mm Length, SS			
50-1057-300S-WB	Threaded Rod, 300mm Length, SS			

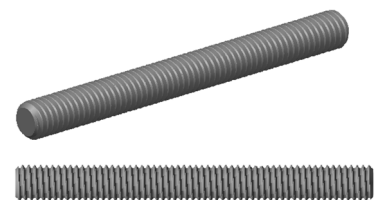

WIRES

ITEM #	DESCRIPTION	QTY	UNIT PRICE	TOTAL
53-700-160200S	K-Wire for 3.2/4.8 Cannulated Drill Bit (3 Pack) - Sterile			
50-1071-16S-WB	Wire - 1.6mm, Bayonet Tip, SS			
50-1071-20S-WB	Wire - 2.0mm, Bayonet Tip, SS			
50-1072-16S-WB	Olive Wire - 1.6mm, Bayonet Tip, SS			
50-1072-20S-WB	Olive Wire - 2.0mm, Bayonet Tip, SS			
50-1062-00S-WB	Wire Stopper Washer, SS			

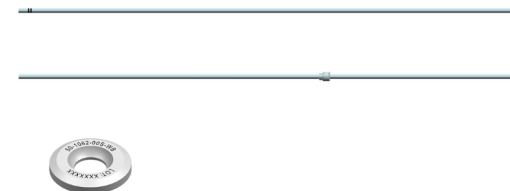

NS signifies Non Sterile.

DELIVERED GOODS FORM (CONTINUED)

SELF DRILLING HALF PINS



	ITEM #	DESCRIPTION	QTY	UNIT PRICE	TOTAL
3MM HALF PIN, 4MM SHAFT	703-310105S	Half Pin, 3.0/105/10mm Self-Drilling/Self-Tapping, QC, SS - NS			
	703-315105S	Half Pin, 3.0/105/15mm Self-Drilling/Self-Tapping, QC, SS - NS			
	703-320105S	Half Pin, 3.0/105/20mm Self-Drilling/Self-Tapping, QC, SS - NS			
	703-325105S	Half Pin, 3.0/105/25mm Self-Drilling/Self-Tapping, QC, SS - NS			
	703-330105S	Half Pin, 3.0/105/30mm Self-Drilling/Self-Tapping, QC, SS - NS			
	703-335105S	Half Pin, 3.0/105/35mm Self-Drilling/Self-Tapping, QC, SS - NS			
	703-340105S	Half Pin, 3.0/105/40mm Self-Drilling/Self-Tapping, QC, SS - NS			
3MM HALF PIN, 4MM SHAFT	703-310150S	Half Pin, 3.0/150/10mm Self-Drilling/Self-Tapping, QC, SS - NS			
	703-315150S	Half Pin, 3.0/150/15mm Self-Drilling/Self-Tapping, QC, SS - NS			
	703-320150S	Half Pin, 3.0/150/20mm Self-Drilling/Self-Tapping, QC, SS - NS			
	703-325150S	Half Pin, 3.0/150/25mm Self-Drilling/Self-Tapping, QC, SS - NS			
	703-330150S	Half Pin, 3.0/150/30mm Self-Drilling/Self-Tapping, QC, SS - NS			
	703-335150S	Half Pin, 3.0/150/35mm Self-Drilling/Self-Tapping, QC, SS - NS			
	703-340150S	Half Pin, 3.0/150/40mm Self-Drilling/Self-Tapping, QC, SS - NS			
3MM HALF PIN, 6MM SHAFT	703-310151S	Half Pin, 3.0/150/10mm Self-Drilling/Self-Tapping, QC, SS - NS			
	703-315151S	Half Pin, 3.0/150/15mm Self-Drilling/Self-Tapping, QC, SS - NS			
	703-320151S	Half Pin, 3.0/150/20mm Self-Drilling/Self-Tapping, QC, SS - NS			
	703-325151S	Half Pin, 3.0/150/25mm Self-Drilling/Self-Tapping, QC, SS - NS			
	703-330151S	Half Pin, 3.0/150/30mm Self-Drilling/Self-Tapping, QC, SS - NS			
	703-335151S	Half Pin, 3.0/150/35mm Self-Drilling/Self-Tapping, QC, SS - NS			
	703-340151S	Half Pin, 3.0/150/40mm Self-Drilling/Self-Tapping, QC, SS - NS			
	703-345151S	Half Pin, 3.0/150/45mm Self-Drilling/Self-Tapping, QC, SS - NS			
	703-350151S	Half Pin, 3.0/150/50mm Self-Drilling/Self-Tapping, QC, SS - NS			
3MM HALF PIN, 6MM SHAFT	703-310200S	Half Pin, 3.0/200/10mm Self-Drilling/Self-Tapping, QC, SS - NS			
	703-315200S	Half Pin, 3.0/200/15mm Self-Drilling/Self-Tapping, QC, SS - NS			
	703-320200S	Half Pin, 3.0/200/20mm Self-Drilling/Self-Tapping, QC, SS - NS			
	703-325200S	Half Pin, 3.0/200/25mm Self-Drilling/Self-Tapping, QC, SS - NS			
	703-330200S	Half Pin, 3.0/200/30mm Self-Drilling/Self-Tapping, QC, SS - NS			
	703-335200S	Half Pin, 3.0/200/35mm Self-Drilling/Self-Tapping, QC, SS - NS			
	703-340200S	Half Pin, 3.0/200/40mm Self-Drilling/Self-Tapping, QC, SS - NS			
	703-345200S	Half Pin, 3.0/200/45mm Self-Drilling/Self-Tapping, QC, SS - NS			
	703-350200S	Half Pin, 3.0/200/50mm Self-Drilling/Self-Tapping, QC, SS - NS			

NS signifies Non Sterile.

DELIVERED GOODS FORM (CONTINUED)

SELF DRILLING HALF PINS



	ITEM #	DESCRIPTION	QTY	UNIT PRICE	TOTAL
4mm HALF PIN, 4mm SHAFT	703-410105S	Half Pin, 4.0/105/10mm Self-Drilling/Self-Tapping, QC, SS - NS			
	703-415105S	Half Pin, 4.0/105/15mm Self-Drilling/Self-Tapping, QC, SS - NS			
	703-420105S	Half Pin, 4.0/105/20mm Self-Drilling/Self-Tapping, QC, SS - NS			
	703-425105S	Half Pin, 4.0/105/25mm Self-Drilling/Self-Tapping, QC, SS - NS			
	703-430105S	Half Pin, 4.0/105/30mm Self-Drilling/Self-Tapping, QC, SS - NS			
	703-435105S	Half Pin, 4.0/105/35mm Self-Drilling/Self-Tapping, QC, SS - NS			
	703-440105S	Half Pin, 4.0/105/40mm Self-Drilling/Self-Tapping, QC, SS - NS			
4mm HALF PIN, 4mm SHAFT	703-410150S	Half Pin, 4.0/150/10mm Self-Drilling/Self-Tapping, QC, SS - NS			
	703-415150S	Half Pin, 4.0/150/15mm Self-Drilling/Self-Tapping, QC, SS - NS			
	703-420150S	Half Pin, 4.0/150/20mm Self-Drilling/Self-Tapping, QC, SS - NS			
	703-425150S	Half Pin, 4.0/150/25mm Self-Drilling/Self-Tapping, QC, SS - NS			
	703-430150S	Half Pin, 4.0/150/30mm Self-Drilling/Self-Tapping, QC, SS - NS			
	703-435150S	Half Pin, 4.0/150/35mm Self-Drilling/Self-Tapping, QC, SS - NS			
	703-440150S	Half Pin, 4.0/150/40mm Self-Drilling/Self-Tapping, QC, SS - NS			
4mm HALF PIN, 6mm SHAFT	703-410151S	Half Pin, 4.0/150/10mm Self-Drilling/Self-Tapping, QC, SS - NS			
	703-415151S	Half Pin, 4.0/150/15mm Self-Drilling/Self-Tapping, QC, SS - NS			
	703-420151S	Half Pin, 4.0/150/20mm Self-Drilling/Self-Tapping, QC, SS - NS			
	703-425151S	Half Pin, 4.0/150/25mm Self-Drilling/Self-Tapping, QC, SS - NS			
	703-430151S	Half Pin, 4.0/150/30mm Self-Drilling/Self-Tapping, QC, SS - NS			
	703-435151S	Half Pin, 4.0/150/35mm Self-Drilling/Self-Tapping, QC, SS - NS			
	703-440151S	Half Pin, 4.0/150/40mm Self-Drilling/Self-Tapping, QC, SS - NS			
	703-445151S	Half Pin, 4.0/150/45mm Self-Drilling/Self-Tapping, QC, SS - NS			
	703-450151S	Half Pin, 4.0/150/50mm Self-Drilling/Self-Tapping, QC, SS - NS			
4mm HALF PIN, 6mm SHAFT	703-410200S	Half Pin, 4.0/200/10mm Self-Drilling/Self-Tapping, QC, SS - NS			
	703-415200S	Half Pin 4.0/200/15mm Self-Drilling/Self-Tapping, QC, SS - NS			
	703-420200S	Half Pin 4.0/200/20mm Self-Drilling/Self-Tapping, QC, SS - NS			
	703-425200S	Half Pin 4.0/200/25mm Self-Drilling/Self-Tapping, QC, SS - NS			
	703-430200S	Half Pin 4.0/200/30mm Self-Drilling/Self-Tapping, QC, SS - NS			
	703-435200S	Half Pin 4.0/200/35mm Self-Drilling/Self-Tapping, QC, SS - NS			
	703-440200S	Half Pin 4.0/200/40mm Self-Drilling/Self-Tapping, QC, SS - NS			
	703-445200S	Half Pin 4.0/200/45mm Self-Drilling/Self-Tapping, QC, SS - NS			
	703-450200S	Half Pin 4.0/200/50mm Self-Drilling/Self-Tapping, QC, SS - NS			

NS signifies Non Sterile.

DELIVERED GOODS FORM (CONTINUED)

BLUNT SELF-TAPPING HALF PINS



	ITEM #	DESCRIPTION	QTY	UNIT PRICE	TOTAL
3MM HALF PIN, 4MM SHAFT	704-310105S	Half Pin, 3.0/105/10mm Blunt Self-Tapping, QC, SS - NS			
	704-315105S	Half Pin, 3.0/105/15mm Blunt Self-Tapping, QC, SS - NS			
	704-320105S	Half Pin, 3.0/105/20mm Blunt Self-Tapping, QC, SS - NS			
	704-325105S	Half Pin, 3.0/105/25mm Blunt Self-Tapping, QC, SS - NS			
	704-330105S	Half Pin, 3.0/105/30mm Blunt Self-Tapping, QC, SS - NS			
	704-335105S	Half Pin, 3.0/105/35mm Blunt Self-Tapping, QC, SS - NS			
	704-340105S	Half Pin, 3.0/105/40mm Blunt Self-Tapping, QC, SS - NS			
3MM HALF PIN, 4MM SHAFT	704-310150S	3.0/150/10mm Half Pin, Blunt Self-Tapping, QC, SS - NS			
	704-315150S	3.0/150/15mm Half Pin, Blunt Self-Tapping, QC, SS - NS			
	704-320150S	3.0/150/20mm Half Pin, Blunt Self-Tapping, QC, SS - NS			
	704-325150S	3.0/150/25mm Half Pin, Blunt Self-Tapping, QC, SS - NS			
	704-330150S	3.0/150/30mm Half Pin, Blunt Self-Tapping, QC, SS - NS			
	704-335150S	3.0/150/35mm Half Pin, Blunt Self-Tapping, QC, SS - NS			
	704-340150S	3.0/150/40mm Half Pin, Blunt Self-Tapping, QC, SS - NS			
3MM HALF PIN, 6MM SHAFT	704-310151S	Half Pin, 3.0/150/10mm Blunt Self-Tapping, QC, SS - NS			
	704-315151S	Half Pin, 3.0/150/15mm Blunt Self-Tapping, QC, SS - NS			
	704-320151S	Half Pin, 3.0/150/20mm Blunt Self-Tapping, QC, SS - NS			
	704-325151S	Half Pin, 3.0/150/25mm Blunt Self-Tapping, QC, SS - NS			
	704-330151S	Half Pin, 3.0/150/30mm Blunt Self-Tapping, QC, SS - NS			
	704-335151S	Half Pin, 3.0/150/35mm Blunt Self-Tapping, QC, SS - NS			
	704-340151S	Half Pin, 3.0/150/40mm Blunt Self-Tapping, QC, SS - NS			
	704-345151S	Half Pin, 3.0/150/45mm Blunt Self-Tapping, QC, SS - NS			
3MM HALF PIN, 6MM SHAFT	704-310200S	Half Pin, 3.0/200/10mm Blunt Self-Tapping, QC, SS - NS			
	704-315200S	Half Pin, 3.0/200/15mm Blunt Self-Tapping, QC, SS - NS			
	704-320200S	Half Pin, 3.0/200/20mm Blunt Self-Tapping, QC, SS - NS			
	704-325200S	Half Pin, 3.0/200/25mm Blunt Self-Tapping, QC, SS - NS			
	704-330200S	Half Pin, 3.0/200/30mm Blunt Self-Tapping, QC, SS - NS			
	704-335200S	Half Pin, 3.0/200/35mm Blunt Self-Tapping, QC, SS - NS			
	704-340200S	Half Pin, 3.0/200/40mm, Blunt Self-Tapping, QC, SS - NS			
	704-345200S	Half Pin, 3.0/200/45mm Blunt Self-Tapping, QC, SS - NS			
704-350200S	Half Pin, 3.0/200/50mm Blunt Self-Tapping, QC, SS - NS				

NS signifies Non Sterile.

DELIVERED GOODS FORM (CONTINUED)

BLUNT SELF-TAPPING HALF PINS



	ITEM #	DESCRIPTION	QTY	UNIT PRICE	TOTAL
4mm HALF PIN, 4mm SHAFT	704-410105S	Half Pin, 4.0/105/10mm Blunt Self-Tapping, QC, SS - NS			
	704-415105S	Half Pin, 4.0/105/15mm Blunt Self-Tapping, QC, SS - NS			
	704-420105S	Half Pin, 4.0/105/20mm Blunt Self-Tapping, QC, SS - NS			
	704-425105S	Half Pin, 4.0/105/25mm Blunt Self-Tapping, QC, SS - NS			
	704-430105S	Half Pin, 4.0/105/30mm Blunt Self-Tapping, QC, SS - NS			
	704-435105S	Half Pin, 4.0/105/35mm Blunt Self-Tapping, QC, SS - NS			
	704-440105S	Half Pin, 4.0/105/40mm Blunt Self-Tapping, QC, SS - NS			
4mm HALF PIN, 4mm SHAFT	704-410150S	Half Pin, 4.0/150/10mm Blunt Self-Tapping, QC, SS - NS			
	704-415150S	Half Pin, 4.0/150/15mm Blunt Self-Tapping, QC, SS - NS			
	704-420150S	Half Pin, 4.0/150/20mm Blunt Self-Tapping, QC, SS - NS			
	704-425150S	Half Pin, 4.0/150/25mm Blunt Self-Tapping, QC, SS - NS			
	704-430150S	Half Pin, 4.0/150/30mm Blunt Self-Tapping, QC, SS - NS			
	704-435150S	Half Pin, 4.0/150/35mm Blunt Self-Tapping, QC, SS - NS			
	704-440150S	Half Pin, 4.0/150/40mm Blunt Self-Tapping, QC, SS - NS			
4mm HALF PIN, 6mm SHAFT	704-410151S	Half Pin, 4.0/150/10mm Blunt Self-Tapping, QC, SS - NS			
	704-415151S	Half Pin, 4.0/150/15mm Blunt Self-Tapping, QC, SS - NS			
	704-420151S	Half Pin, 4.0/150/20mm Blunt Self-Tapping, QC, SS - NS			
	704-425151S	Half Pin, 4.0/150/25mm Blunt Self-Tapping, QC, SS - NS			
	704-430151S	Half Pin, 4.0/150/30mm Blunt Self-Tapping, QC, SS - NS			
	704-435151S	Half Pin, 4.0/150/35mm Blunt Self-Tapping, QC, SS - NS			
	704-440151S	Half Pin, 4.0/150/40mm Blunt Self-Tapping, QC, SS - NS			
	704-445151S	Half Pin, 4.0/150/45mm Blunt Self-Tapping, QC, SS - NS			
	704-450151S	Half Pin, 4.0/150/50mm Blunt Self-Tapping, QC, SS - NS			
4mm HALF PIN, 6mm SHAFT	704-410200S	Half Pin, 4.0/200/10mm Blunt Self-Tapping, QC, SS - NS			
	704-415200S	Half Pin, 4.0/200/15mm Blunt Self-Tapping, QC, SS - NS			
	704-420200S	Half Pin, 4.0/200/20mm Blunt Self-Tapping, QC, SS - NS			
	704-425200S	Half Pin, 4.0/200/25mm Blunt Self-Tapping, QC, SS - NS			
	704-430200S	Half Pin, 4.0/200/30mm Blunt Self-Tapping, QC, SS - NS			
	704-435200S	Half Pin, 4.0/200/35mm Blunt Self-Tapping, QC, SS - NS			
	704-440200S	Half Pin, 4.0/200/40mm, Blunt Self-Tapping, QC, SS - NS			
	704-445200S	Half Pin, 4.0/200/45mm Blunt Self-Tapping, QC, SS - NS			
	704-450200S	Half Pin, 4.0/200/50mm Blunt Self-Tapping, QC, SS - NS			

NS signifies Non Sterile.

DELIVERED GOODS FORM (CONTINUED)

SELF DRILLING HALF PINS



	ITEM #	DESCRIPTION	QTY	UNIT PRICE	TOTAL
4.5MM	50-1845-122S-WB	Half Pin, 4.5/120/20mm, Self Drilling, QC, SS			
	50-1845-123S-WB	Half Pin, 4.5/120/30mm, Self Drilling, QC, SS			
	50-1845-124S-WB	Half Pin, 4.5/120/40mm, Self Drilling, QC, SS			
	50-1845-152S-WB	Half Pin, 4.5/150/20mm, Self Drilling, QC, SS			
	50-1845-153S-WB	Half Pin, 4.5/150/30mm, Self Drilling, QC, SS			
	50-1845-154S-WB	Half Pin, 4.5/150/40mm, Self Drilling, QC, SS			
	50-1845-155S-WB	Half Pin, 4.5/150/50mm, Self Drilling, QC, SS			
5.0MM	50-1850-123S-WB	Half Pin, 5.0/120/30mm, Self Drilling, QC, SS			
	50-1850-124S-WB	Half Pin, 5.0/120/40mm, Self Drilling, QC, SS			
	50-1850-153S-WB	Half Pin, 5.0/150/30mm, Self Drilling, QC, SS			
	50-1850-154S-WB	Half Pin, 5.0/150/40mm, Self Drilling, QC, SS			
	50-1850-155S-WB	Half Pin, 5.0/150/50mm, Self Drilling, QC, SS			
	50-1850-183S-WB	Half Pin, 5.0/180/30mm, Self Drilling, QC, SS			
	50-1850-184S-WB	Half Pin, 5.0/180/40mm, Self Drilling, QC, SS			
	50-1850-185S-WB	Half Pin, 5.0/180/50mm, Self Drilling, QC, SS			
	50-1850-203S-WB	Half Pin, 5.0/200/30mm, Self Drilling, QC, SS			
	50-1850-204S-WB	Half Pin, 5.0/200/40mm, Self Drilling, QC, SS			
	50-1850-205S-WB	Half Pin, 5.0/200/50mm, Self Drilling, QC, SS			
	50-1850-223S-WB	Half Pin, 5.0/220/30mm, Self Drilling, QC, SS			
	50-1850-224S-WB	Half Pin, 5.0/220/40mm, Self Drilling, QC, SS			
	50-1850-225S-WB	Half Pin, 5.0/220/50mm, Self Drilling, QC, SS			
	50-1850-253S-WB	Half Pin, 5.0/250/30mm, Self Drilling, QC, SS			
	50-1850-254S-WB	Half Pin, 5.0/250/40mm, Self Drilling, QC, SS			
	50-1850-255S-WB	Half Pin, 5.0/250/50mm, Self Drilling, QC, SS			
6.0MM	50-1860-153S-WB	Half Pin, 6.0/150/30mm, Self Drilling, QC, SS			
	50-1860-154S-WB	Half Pin, 6.0/150/40mm, Self Drilling, QC, SS			
	50-1860-183S-WB	Half Pin, 6.0/180/30mm, Self Drilling, QC, SS			
	50-1860-184S-WB	Half Pin, 6.0/180/40mm, Self Drilling, QC, SS			
	50-1860-203S-WB	Half Pin, 6.0/200/30mm, Self Drilling, QC, SS			
	50-1860-204S-WB	Half Pin, 6.0/200/40mm, Self Drilling, QC, SS			
	50-1860-205S-WB	Half Pin, 6.0/200/50mm, Self Drilling, QC, SS			
	50-1860-223S-WB	Half Pin, 6.0/220/30mm, Self Drilling, QC, SS			
	50-1860-224S-WB	Half Pin, 6.0/220/40mm, Self Drilling, QC, SS			
	50-1860-225S-WB	Half Pin, 6.0/220/50mm, Self Drilling, QC, SS			
	50-1860-253S-WB	Half Pin, 6.0/250/30mm, Self Drilling, QC, SS			
	50-1860-254S-WB	Half Pin, 6.0/250/40mm, Self Drilling, QC, SS			
	50-1860-255S-WB	Half Pin, 6.0/250/50mm, Self Drilling, QC, SS			

NS signifies Non Sterile.

DELIVERED GOODS FORM (CONTINUED)

BLUNT SELF TAPPING HALF PINS



	ITEM #	DESCRIPTION	QTY	UNIT PRICE	TOTAL
4.5MM	50-1845-122BL-WB	Half Pin, 4.5/120/20mm, Blunt Self Tapping, QC, SS			
	50-1845-123BL-WB	Half Pin, 4.5/120/30mm, Blunt Self Tapping, QC, SS			
	50-1845-124BL-WB	Half Pin, 4.5/120/40mm, Blunt Self Tapping, QC, SS			
	50-1845-153BL-WB	Half Pin, 4.5/150/30mm, Blunt Self Tapping, QC, SS			
	50-1845-154BL-WB	Half Pin, 4.5/150/40mm, Blunt Self Tapping, QC, SS			
5.0MM	50-1850-123BL-WB	Half Pin, 5.0/120/30mm, Blunt Self Tapping, QC, SS			
	50-1850-124BL-WB	Half Pin, 5.0/120/40mm, Blunt Self Tapping, QC, SS			
	50-1850-153BL-WB	Half Pin, 5.0/150/30mm, Blunt Self Tapping, QC, SS			
	50-1850-154BL-WB	Half Pin, 5.0/150/40mm, Blunt Self Tapping, QC, SS			
	50-1850-155BL-WB	Half Pin, 5.0/150/50mm, Blunt Self Tapping, QC, SS			
	50-1850-183BL-WB	Half Pin, 5.0/180/30mm, Blunt Self Tapping, QC, SS			
	50-1850-184BL-WB	Half Pin, 5.0/180/40mm, Blunt Self Tapping, QC, SS			
	50-1850-185BL-WB	Half Pin, 5.0/180/50mm, Blunt Self Tapping, QC, SS			
	50-1850-203BL-WB	Half Pin, 5.0/200/30mm, Blunt Self Tapping, QC, SS			
	50-1850-204BL-WB	Half Pin, 5.0/200/40mm, Blunt Self Tapping, QC, SS			
	50-1850-205BL-WB	Half Pin, 5.0/200/50mm, Blunt Self Tapping, QC, SS			
	50-1850-223BL-WB	Half Pin, 5.0/220/30mm, Blunt Self Tapping, QC, SS			
	50-1850-224BL-WB	Half Pin, 5.0/220/40mm, Blunt Self Tapping, QC, SS			
	50-1850-225BL-WB	Half Pin, 5.0/220/50mm, Blunt Self Tapping, QC, SS			
	50-1850-253BL-WB	Half Pin, 5.0/250/30mm, Blunt Self Tapping, QC, SS			
50-1850-254BL-WB	Half Pin, 5.0/250/40mm, Blunt Self Tapping, QC, SS				
50-1850-255BL-WB	Half Pin, 5.0/250/50mm, Blunt Self Tapping, QC, SS				
6.0MM	50-1860-153BL-WB	Half Pin, 6.0/150/30mm, Blunt Self Tapping, QC, SS			
	50-1860-154BL-WB	Half Pin, 6.0/150/40mm, Blunt Self Tapping, QC, SS			
	50-1860-183BL-WB	Half Pin, 6.0/180/30mm, Blunt Self Tapping, QC, SS			
	50-1860-184BL-WB	Half Pin, 6.0/180/40mm, Blunt Self Tapping, QC, SS			
	50-1860-203BL-WB	Half Pin, 6.0/200/30mm, Blunt Self Tapping, QC, SS			
	50-1860-204BL-WB	Half Pin, 6.0/200/40mm, Blunt Self Tapping, QC, SS			
	50-1860-205BL-WB	Half Pin, 6.0/200/50mm, Blunt Self Tapping, QC, SS			
	50-1860-223BL-WB	Half Pin, 6.0/220/30mm, Blunt Self Tapping, QC, SS			
	50-1860-224BL-WB	Half Pin, 6.0/220/40mm, Blunt Self Tapping, QC, SS			
	50-1860-253BL-WB	Half Pin, 6.0/250/30mm, Blunt Self Tapping, QC, SS			
50-1860-254BL-WB	Half Pin, 6.0/250/40mm, Blunt Self Tapping, QC, SS				

NS signifies Non Sterile.

DELIVERED GOODS FORM (CONTINUED)

SELF DRILLING HA HALF PINS - STERILE



ITEM #	DESCRIPTION	QTY	UNIT PRICE	TOTAL
11-701-360120S-0	HA Half Pin, 6mm, 120X30, Self Drilling			
11-701-360150S-0	HA Half Pin, 6mm, 150X40, Self Drilling			
11-701-256150S-0	HA Half Pin, 6mm, 150X44, Self Drilling			
11-701-360180S-0	HA Half Pin, 6mm, 180X50, Self Drilling			

SELF DRILLING HALF PINS HA EXTENDED ONTO SHAFT - STERILE



ITEM #	DESCRIPTION	QTY	UNIT PRICE	TOTAL
11-701-360148S-0	HA Half Pin, Extended Coating, 6mm, 150X30, Self Drilling			
11-701-360178S-0	HA Half Pin, Extended Coating, 6mm, 180X35, Self Drilling			
11-701-360198S-0	HA Half Pin, Extended Coating, 6mm, 200X40, Self Drilling			

HA HALF PINS - STERILE (DRILLING NEEDED)



ITEM #	DESCRIPTION	QTY	UNIT PRICE	TOTAL
11-701-156150S-0	HA Half Pin, 6mm, 150X40			
11-701-156180S-0	HA Half Pin, 6mm, 180X50			

ITEM #	DESCRIPTION	QTY	UNIT PRICE	TOTAL
51-701-401335S-0*	Drill Bit For HA Half Pins, Long - Sterile			
51-701-401325S-0*	Drill Bit For HA Half Pins, Short - Sterile			
51-700-003220G-0	AO Drill Bit 3.2 x 200mm - Sterile			
51-700-004820G-0	AO Drill Bit 4.8 x 200mm - Sterile			
51-720-032200S	Cannulated Drill Bit 3.2 x 200mm - Sterile			
51-720-048200S	Cannulated Drill Bit 4.8 x 200mm - Sterile			
51-720-020150S	Solid Drill Bit 2.0 x 150mm - Sterile			
51-720-028150S	Solid Drill Bit 2.8 x 150mm - Sterile			



*These components are provided sterile packed and are intended to be used with HA Half Pins.

DELIVERED GOODS FORM (CONTINUED)

NON-STERILE ACCESSORIES

ITEM #	DESCRIPTION	QTY	UNIT PRICE	TOTAL
00-STID-00-WB	Standard Strut ID Clips (6 pack) - Non-Sterile			
10-702-000030-1	Express Strut ID Clips (6 pack) - Non-Sterile			
50-1015-00-WB	Walking Foot Attachment - Non-Sterile			
720-000040G	Half Pin Cover, 4mm - Non-Sterile			
50-1800-06-WB	Half Pin Cover, 6mm - Non-Sterile			
50-1070-16S-WB	Wire Cover, 1.6mm - Non-Sterile			
50-1070-20S-WB	Wire Cover, 2.0mm - Non-Sterile			
000502	Sponge Clips (12 pack) - Non-Sterile			

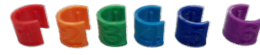

DELIVERED GOODS FORM (CONTINUED)

ADDITIONAL SINGLE-USE STERILE OFFERINGS

ITEM #	DESCRIPTION	QTY	UNIT PRICE	TOTAL
PK-602028	Single Use Drill Sleeve Guide 6mm and Inserts - Sterile			
PK-402028	Single Use Drill Sleeve Guide 4mm and Inserts - Sterile			
950S	Pin Site Sponge Sterile Pack (30 Sponges)			
51-701-601306G-0*	6mm AO Quick Release Adaptor			
11-700-105201T-0	Standard Nut			
11-700-115306T-0	Shoulder Bolt, 6mm			
11-700-115308T-0	Shoulder Bolt, 8mm			
00-STID-00-WBSP	Standard Strut ID Clips (6 Pack) - Sterile			
53-720-000040G	Half Pin Covers, 4mm (3 pack)			
50-60PC-03SP	Half Pin Covers, 6mm (3 pack)			
50-20WC-02SP	Wire Cover, 2.0 (2 pack)			
50-16WC-02SP	Wire Cover, 1.6 (2 pack)			
50-1062-00S-WBSP	Wire Stopper Washer, SS (3 pack)			
50-1052-03-WBSP	Long Nut (12.8mm)			
50-1051-01-WBSP	Locking Washer (6 pack)			
50-1056-60-WBSP	Pin Sleeve and Set Screw			
IVCD-15	Lifesaver® Ag – 1" Diameter with 1.5mm ID (for Wires)			
IVCD-40	Lifesaver® Ag – 1" Diameter with 4.0mm ID (for Half Pins)			



*These components are provided sterile packed and are intended to be used with HA Half Pins.